



Datenblatt - Fiche technique - Data sheet

21.99.0844



VALUE S/FTP-(PiMF-)Patchkabel Kat.6A, Massivdraht, LSOH, grau, 20,0 m

Cordon VALUE Cat.6A S/FTP (PiMF) solide LSOH, gris, 20,0 m

VALUE S/FTP Patch Cord Cat.6A, solid, LSOH, grey, 20.0 m

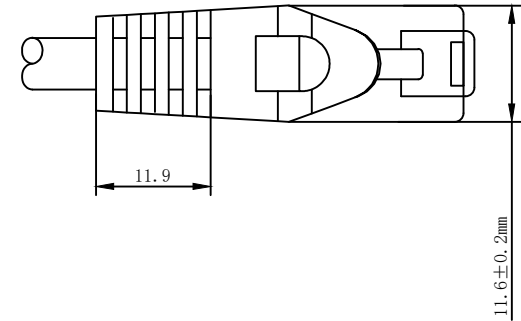
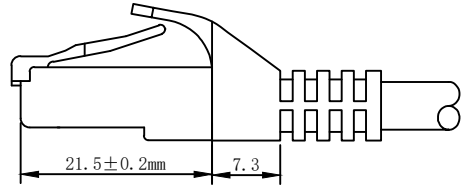
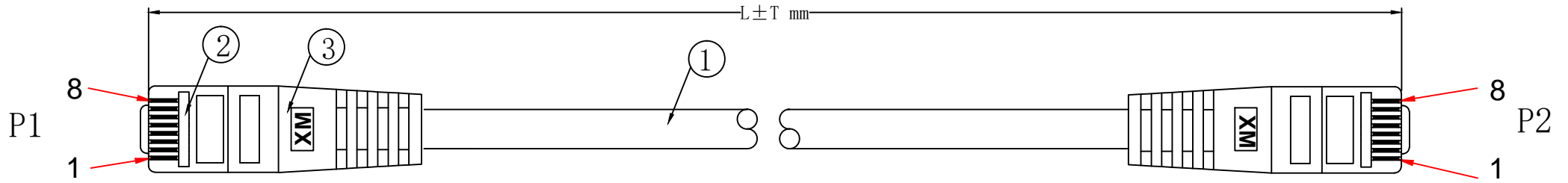

WIRING DIAGRAM

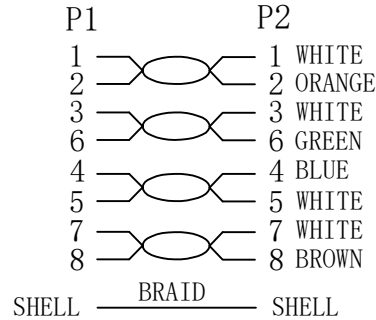

NOTE:

- 100% OPEN SHORT, MISS WIRE TEST
- Fluke channel test: (L ≤ 60m)
TEST LIMIT: ISO 11801 Channel Class EA
- SPRAY WORD: CAT. 6A S/FTP LSZH 500MHz ISO/IEC 11801 & EN 50173-1 & ANSI/TIA-568-C.2
- ROHS2.0 AND REACH COMPLIANT

MATERIAL LIST

③	OVER MOLD	75A PVC	2	
②	CONNECTOR	RJ45 8P8C shielded Plug, Pin Gold Plated 3u", Transparent	2	
①	CABLE	S/FTP CAT. 6A (1/26AWGBC*1P+AL-FOIL)*4PAIRS+ JACKET:LSOH/Gray(warm gray 3C) OD:6.2±0.2mm	1	

ITEM	LENGTH
21.99.0844	20000 ± 300mm
21.99.0846	30000 ± 300mm
21.99.0847	50000 ± 400mm
21.99.0848	70000 ± 400mm
21.99.0849	90000 ± 400mm

NO.	PARTS NAME	SPECIFICATION STANDARD	QT' Y	REMARK
		NEW		2016-05-19
BY	CHK	REVISION RECORD MODIFICATION		DATE
				REV.

DESC. VALUE CAT 6A S/FTP SOLID PATCH CORD, LSOH, GREY

