

USER GUIDE

HeeHee

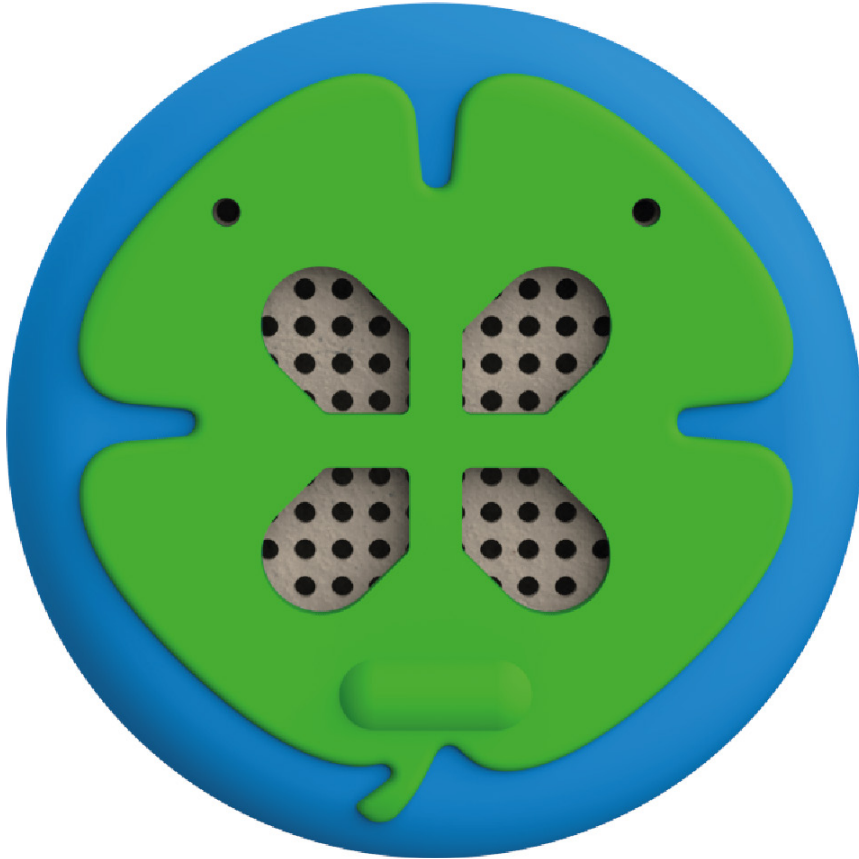

“Bring your favorite cuddly toy alive!”

Alecto
Powered by **Lenco**





Read the manual

Always scan the QR code inside the packaging artwork of the product HeeHee to go to the latest version of this product's user manual. Carefully read this user manual and follow all instructions including the 'Help' information. If you still can't get out, please contact our customer care service. Always keep this instruction manual cause it contains important information!



Safety requirements

- Don't attempt to repair or modify any electrical or mechanical functions of this product, this will declare the warranty as void.
- Replacement of the battery is not possible. Please do not attempt to change these batteries yourself. Instead, contact our customer support for repair or replacement information or engage a professional to service or replace the battery.
- Although the product is waterproof IPX4, please try to keep the product away from any liquids.
- Disposal of the product into fire or a hot oven, or mechanical crush or cutting may damage the included battery and may result in an explosion.
- Leaving the product with included battery in an extremely high temperature surrounding environment may result in an explosion or the leakage of flammable liquid or gas.
- Subject the product with included battery to extremely low air pressure may result in an explosion or the leakage of flammable liquid or gas.
- The battery charger used with the toy should be regularly examined for potential hazard, such as damage to the cable or cord, plug, enclosure of other parts and that in the event of such damage the toy must not be used until that damage had been properly removed.
- This toy contains battery that is non-replaceable, only use the supplied USB cable.
- The toy is only to be connected to equipment bearing either of the following symbols  or 

General information

- For safety reasons, there is a sound limitation set on HeeHee. It is not possible to exceed this.
 - Phone calls do not come in via HeeHee.
 - Explanation of the colors of the lights
- Off = no connection or battery completely empty
Blue fast blinking = searching for Bluetooth connection
Blue blinking slowly = connected to Bluetooth
Red blinking = low battery
- Press and hold HeeHee button for 3 seconds = on/off (once connected, HeeHee remains in phone memory unless disconnected).
 - Pressing button HeeHee 3 times in quick succession = disconnect Bluetooth connection between HeeHee and smartphone immediately.
 - Compatible Android versions: 5.0 or higher
 - Compatible iOS versions: 10 or higher

CONTENT

Read the manual.....	1
Safety requirements.....	1
General information.....	1
How to install ? / How to use ?.....	4
1. Download the HeeHee APP.....	4
2. Allow the APP your Location, Microphone, Files and Media.....	4
3. How to connect HeeHee to your smartphone ?.....	4
4. Go back to the HeeHee APP.....	5
5. Overview of the HeeHee device.....	5
6. How to attach HeeHee to your cuddle toy ?.....	5
7. Charging and turning HeeHee ON/OFF.....	6
8. How to use the App HeeHee ?.....	6
Help.....	8
Disposal of the old device.....	9
CE marking.....	9
Declaration of conformity.....	9

Connection/installation:

- If HeeHee does not want to connect with Bluetooth, only Hee(BLE) visible, then check if GPS location is 'on'.
- Only one HeeHee can be connected per smartphone. Because the HeeHee connects to the phone via BlueTooth, it is otherwise not possible to pass different signals to the HeeHee.
- While installing the app, it is important that you give permission to all rights: location, photos/media, microphone, storage, phone, call lists.

How to install the QR code



1. Scan the QR code with the android camera app

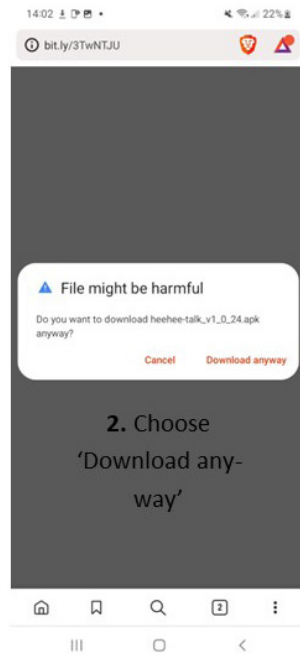

2. Choose 'Download anyway'



3. Downloading will start



4. Press the APK file you just downloaded

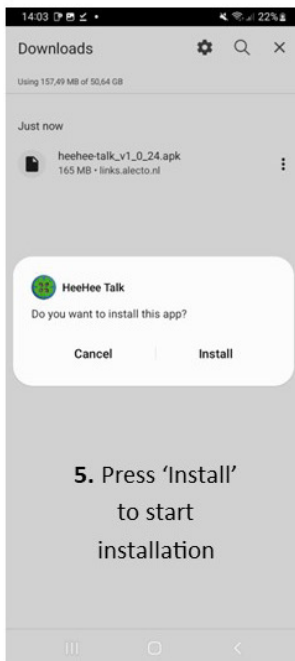

5. Press 'Install' to start installation

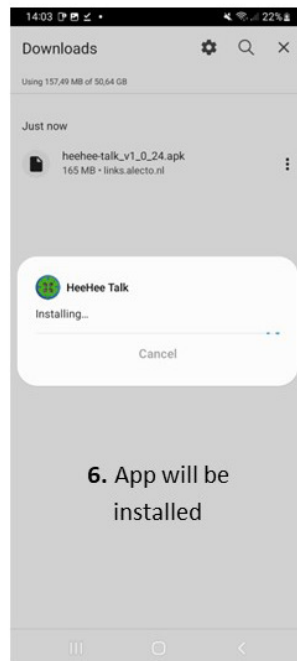

6. App will be installed

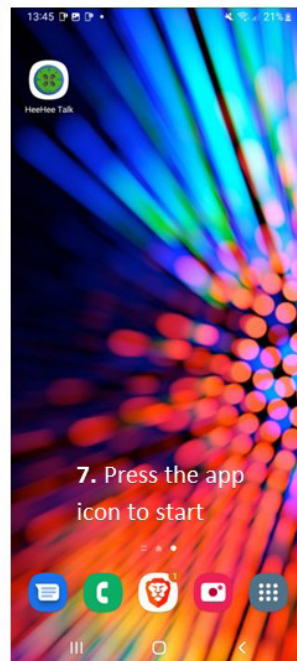

7. Press the app icon to start

How to install ? / How to use ?

1. Download the HeeHee APP

A special smartphone APP is required to use HeeHee.
Download the 'HeeHee Talk' APP from the banner below or search in the Google Play Store / App Store to the application 'HeeHee Talk'.



HeeHee Talk



Use the QR code to download the app and follow the instructions on page 3.

2. Tap and hold the HeeHee APP and allow the APP HeeHee your Location, Microphone, Files and media

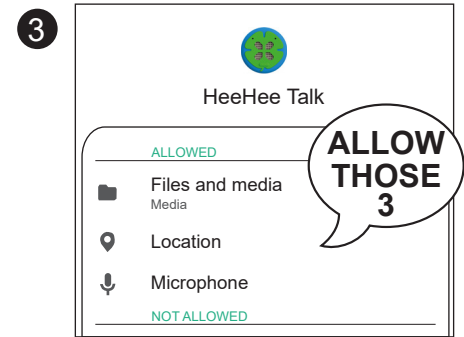
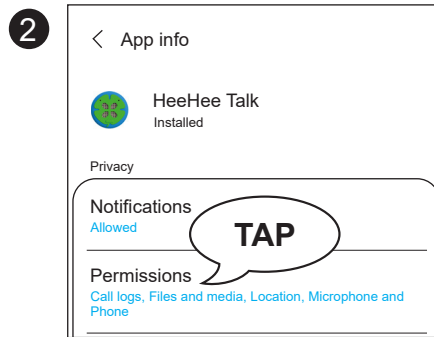
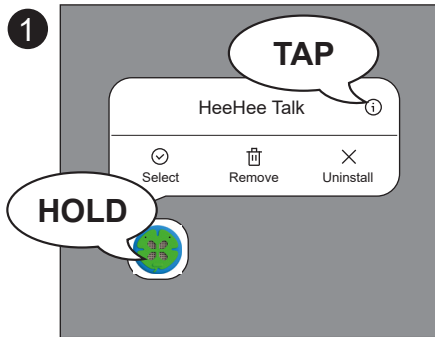

3. How to connect HeeHee to your smartphone ?

First open the HeeHee APP and click 'OK' in the pop-up.
Turn on the HeeHee button by pressing the power button (see paragraph '5. Overview') for 5 seconds.

Android users:

In Bluetooth settings turn the Bluetooth 'ON' and select 'HeeHee'

iPhone users:

In Bluetooth settings turn the Bluetooth 'ON' and select 'HeeHee'

Note: Don't select 'Hee(BLE)'

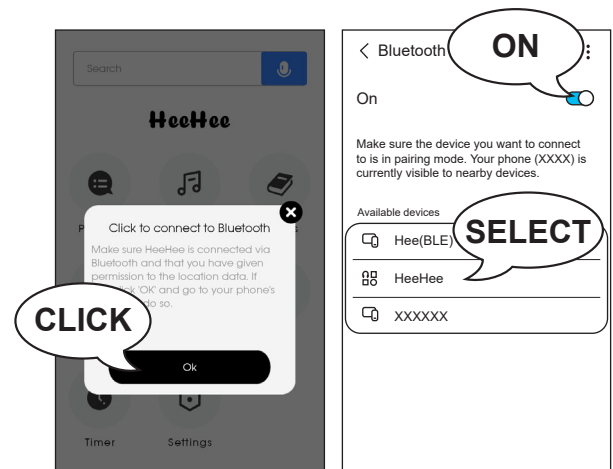

4. Go back to the HeeHee APP

Always wait for the pop-up “Successful” to appear in the APP. Select your preferred language in the settings; EN English, NL Dutch, FR French, DE German. You can also check in the settings of the APP if the HeeHee is connected correctly.

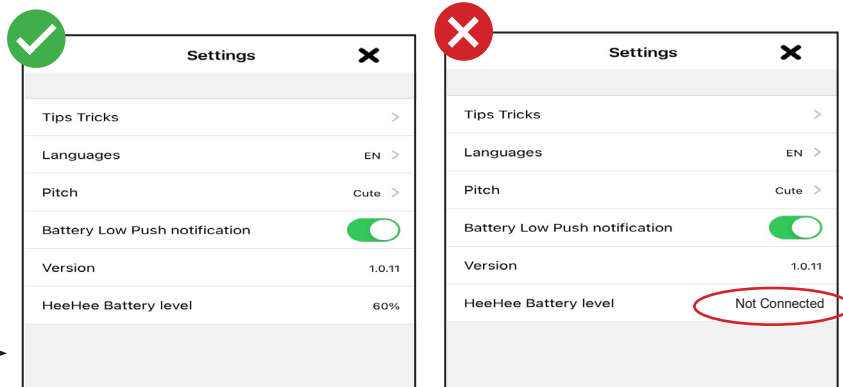

5. Overview of the HeeHee device

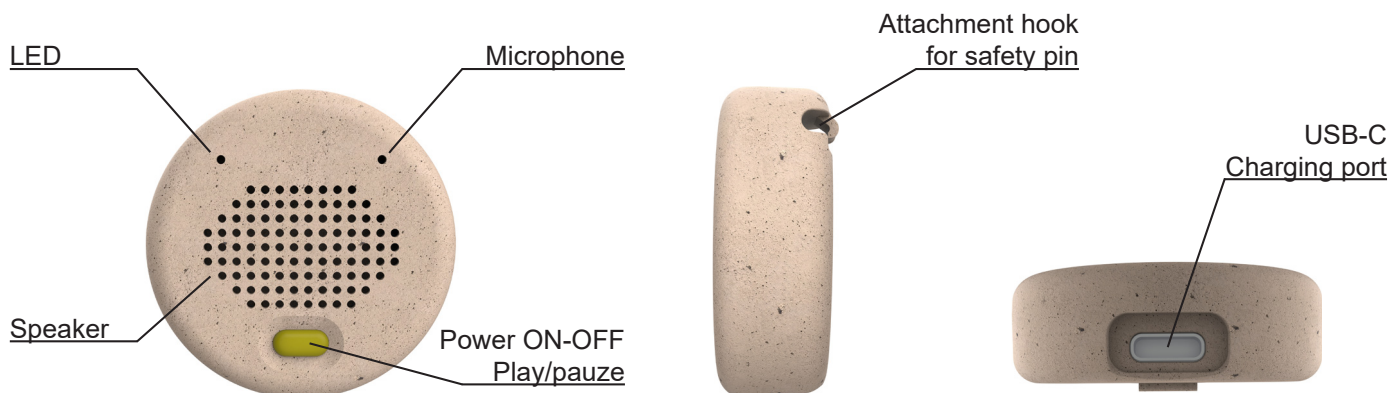

6. How to attach HeeHee to your cuddle toy ?

Accessories needed:

- Your favorite cuddle toy
- Velcro tape: 1 hook and 3 loops.
- Needle and thread



The hard side of the Velcro is called the hook.

1. Stick the hard side with the glued side to the back side of button HeeHee. The soft side of the Velcro is called the loop.

Secure the soft side without glue to the cuddle toy by sewing it with needle and thread. If you have a cuddle toy with hard plastic parts, you can also attach the Velcro by sticking it with the glued soft part.



Tip: It's possible to attach button HeeHee to more than 1 cuddle toy because of the 3 included soft sides.

7. Charging and turning HeeHee ON/OFF

Charging time: appr. 3 hours

Usage time:

- Constantly connected with Bluetooth (for example when crying detection is activated): 6 to 7 hours

-

Note:

- Battery saving after 30 minutes of no use in the APP, then Bluetooth connection will be broken.

Battery related:

- If the battery is low, and in 'Settings' the Battery low push notification is activated, you'll receive a pop-up in the app every minute.

- HeeHee battery charging takes about 3 hours. Red light off and connected to power = battery charged.

- It is possible to use HeeHee as normal when it is connected to power.



Use original
USB-C cable
to charge



Long press
for 5 seconds
to turn ON/OFF

8. How to use the App HeeHee ?

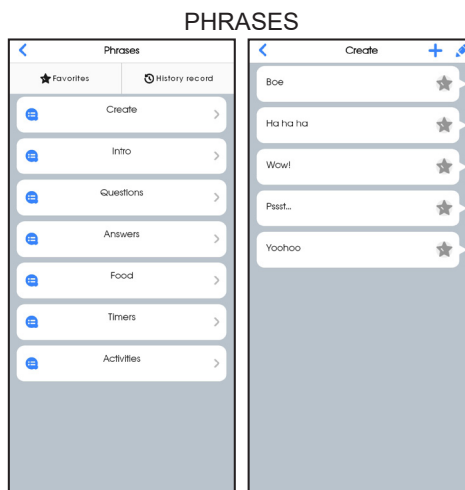
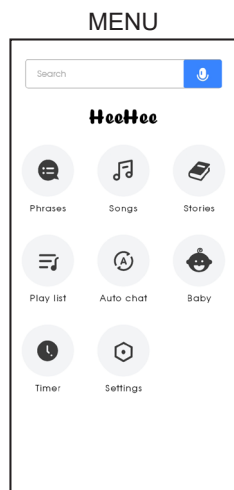

Sidenote:

Adults can also use the HeeHee to let the cuddly toy speak to their loved ones.

You can use it for a marriage proposal / making up after a fight or use it for a surprise event.

SONGS

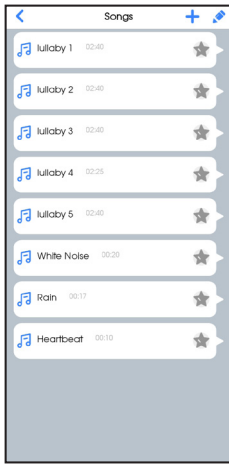

Songs are played through APP, not through the HeeHee locally.

STORIES

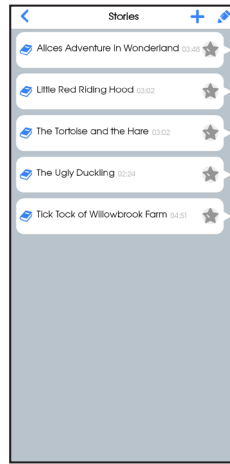

PLAYLIST

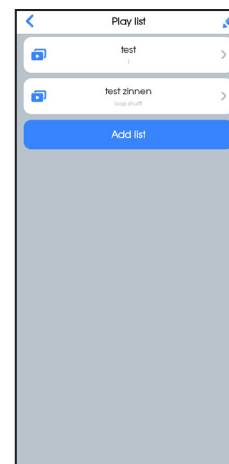

It is not possible to change the file name of a playlist. If you want to change the playlist name you need to create a new playlist.

IMITATION

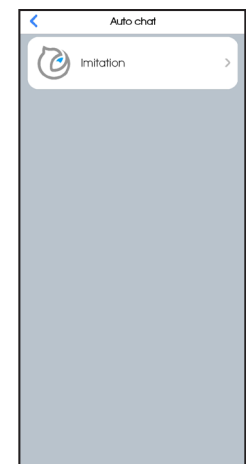

The imitation function on Hee-Hee only works within Bluetooth range.

CRY DETECTION

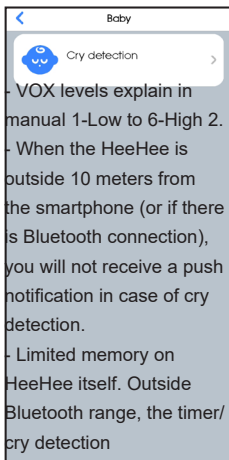

function, extra recorded songs/voices cannot be played.

- Due to limited memory on the HeeHee itself, it is not possible to play recorded songs or texts outside the Bluetooth range.

TIMER

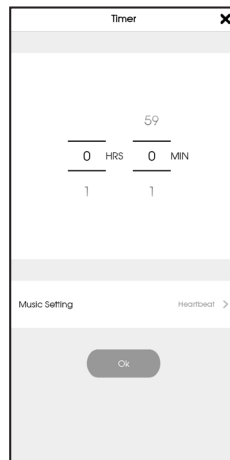

Due to a limited memory on the HeeHee itself, it is not possible to play recorded songs or texts outside of the Bluetooth range.

MICROPHONE

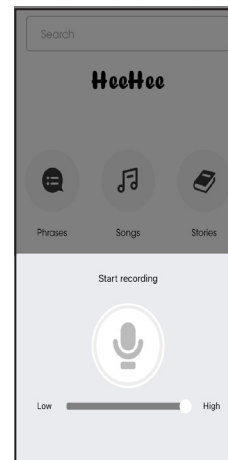

Outside Bluetooth range, the microphone function does not work properly. Microphone then falters.

SETTINGS

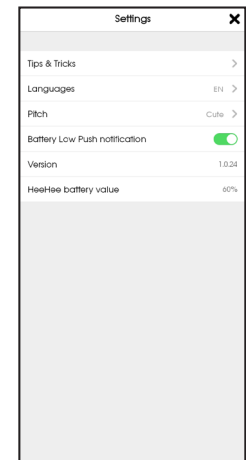

Help

Can't connect to HeeHee ?

- Is HeeHee turned on?
Press and hold the power button on the frontside of HeeHee for five seconds to turn the power on. If HeeHee is almost out of battery, you'll see a red light, please charge it using the provided charging cable. If the light won't turn on, the battery is completely empty. You first need to charge the HeeHee before you can use it.
- Are you close enough to HeeHee?
Make sure you are within 10 meters (without any obstacles) from HeeHee to connect with Bluetooth.
- Is HeeHee connected to another smartphone?
HeeHee can only be connected to **one** smartphone at a time. Disconnect HeeHee from the paired smartphone and try again.
- Is your smartphone connected to other Bluetooth devices?
Please make sure that your smartphone is not connected to any other device via Bluetooth. Even in case you were able to pair HeeHee to your smartphone while being connected to another Bluetooth device, HeeHee may not function properly. Please disconnect all Bluetooth devices before pairing with HeeHee.
- Are you near a microwave or other equipment that emits electromagnetic waves?
Please use HeeHee away from equipment that emits electromagnetic waves.

"HeeHee" doesn't show up on my smartphone Bluetooth device selection screen.

- Please try the following:
 - Open "Settings" on you smartphone. Disable Bluetooth and then try turning it on again.
 - Turn off the HeeHee device and try returning it on again.

Cannot operate APP even though smartphone and HeeHee device are properly paired.

- Is your smartphone paired with any Bluetooth device other that HeeHee?
Even in case you were able to pair HeeHee to your smartphone while being connected to another Bluetooth device, HeeHee may not function properly. Please disconnect all Bluetooth devices before pairing with HeeHee.

HeeHee can't be turned on.

- Press and hold the power button for 5 seconds.
Press and hold the power button at the backside of HeeHee for five seconds to turn on the power.
- Is HeeHee fully charged?
 - Please fully charge HeeHee using the provided charging cable.
 - HeeHee may be broken. Please contact Alecto customer service: info@alecto.com

The app keeps terminating abnormally.

- The problem may be due to insufficient memory on your smartphone. Please close other apps that are running or restart your smartphone and see if there is an improvement. Refer to your smartphone manual for operating instructions.

I'm changing my smartphone and want to transfer HeeHee data to my new phone.

- It's not possible to transfer data from HeeHee to your smartphone or computer.

For malfunctions and repairs

Please contact Alecto customer service: info@alecto.com

Customer support

E-mail: info@alecto.com



Disposal of the old device

This symbol indicates that the relevant electrical product or battery should not be disposed of as general household waste in Europe. To ensure the correct waste treatment of the product and battery, please dispose them in accordance to any applicable local laws of requirement for disposal of electrical equipment or batteries. In so doing, you will help to conserve natural resources and improve standards of environmental protection in treatment and disposal of electrical waste (Waste Electrical and Electronic Equipment Directive).



CE Marking

This product is in compliance with the essential EU directive requirements.

DECLARATION OF CONFORMITY

Hereby, Commaxx declares that the radio equipment type Alecto HeeHee is in compliance with directive 2014/53/EU. The full text of the EU declaration of conformity is available at the following internet address:
http://DOC.hesdo.com/HeeHee_DOC.pdf

Alecto *HeeHee*
Powered by **Lenco**

Commaxx B.V.
Wiebachstraat 37
6466NG Kerkrade
The Netherlands

www.alectobaby.com



v1.0